

INSULA DE PROTECTIE TIP A 1400 x 1000 x 1000
scara 1:20

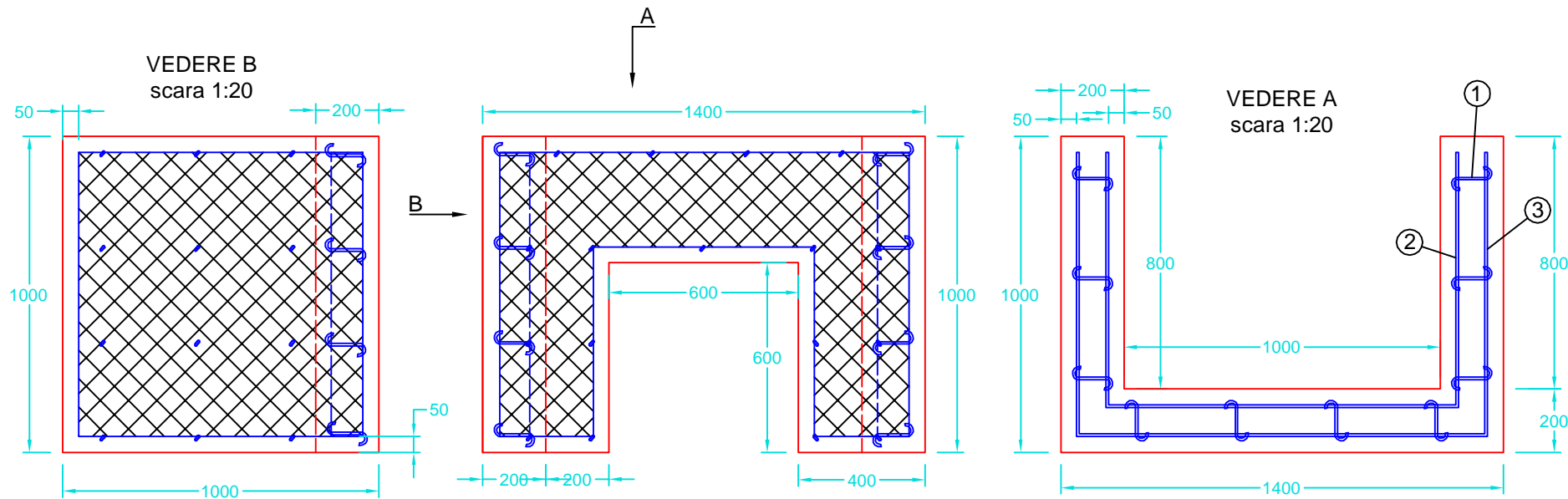

3. DETALIU PLASA SUDATA STNB DESFASURATA
Ø8mm cu ochiuri de 100 x 100mm (tip Buzau), l=3084mm
scara 1:20

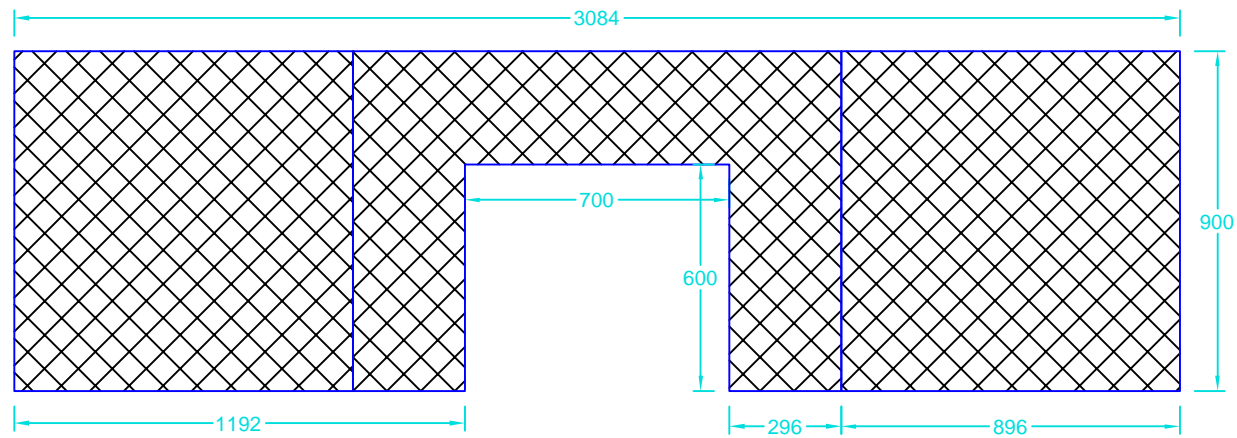

1. DETALIU SCOABA
Ø6mm, l=202mm
scara 1:10

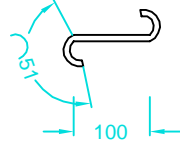

2. DETALIU PLASA SUDATA STNB DESFASURATA
Ø8mm cu ochiuri de 100 x 100mm (tip Buzau), l=2716mm
scara 1:20

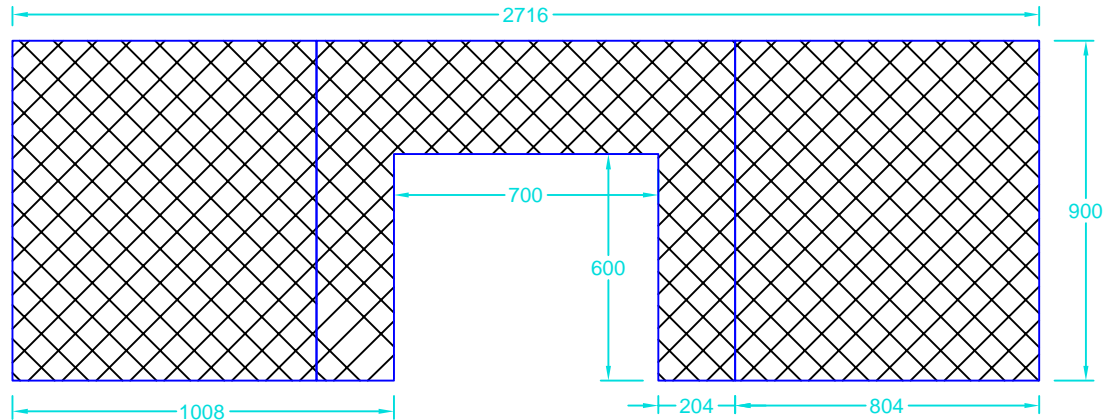

INSULA DE PROTECTIE TIP B 1400 x 1000 x 1000
scara 1:20

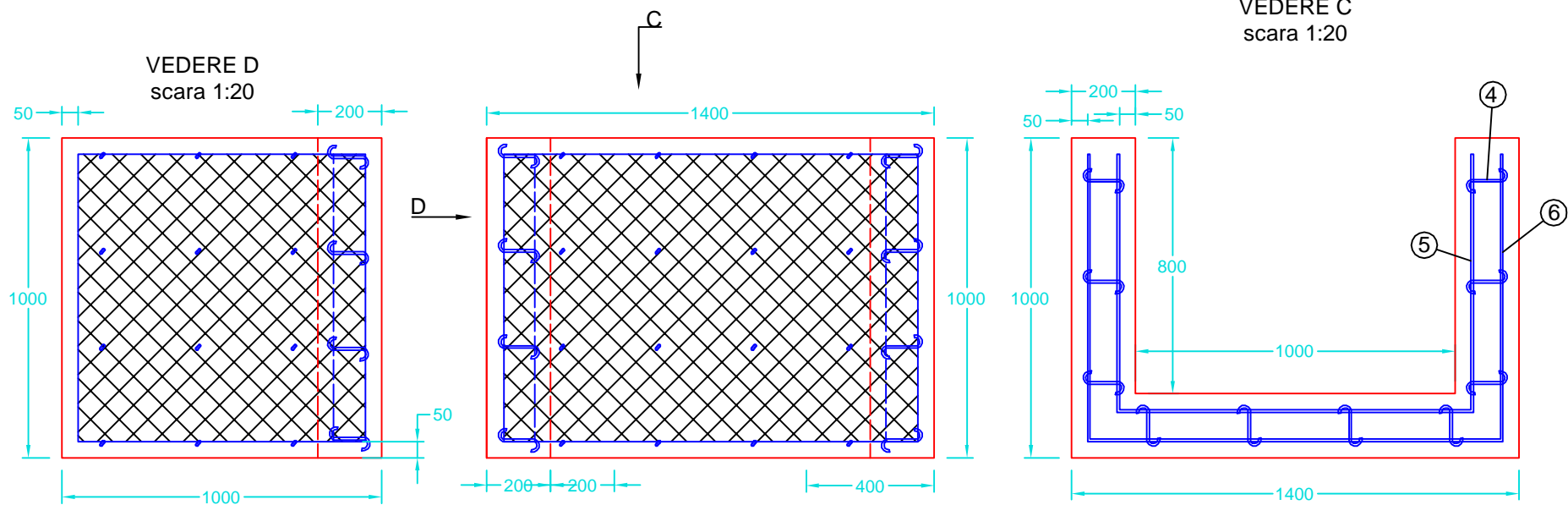

6. DETALIU PLASA SUDATA STNB DESFASURATA
Ø8mm cu ochiuri de 100 x 100mm (tip Buzau), l=3084mm
scara 1:20

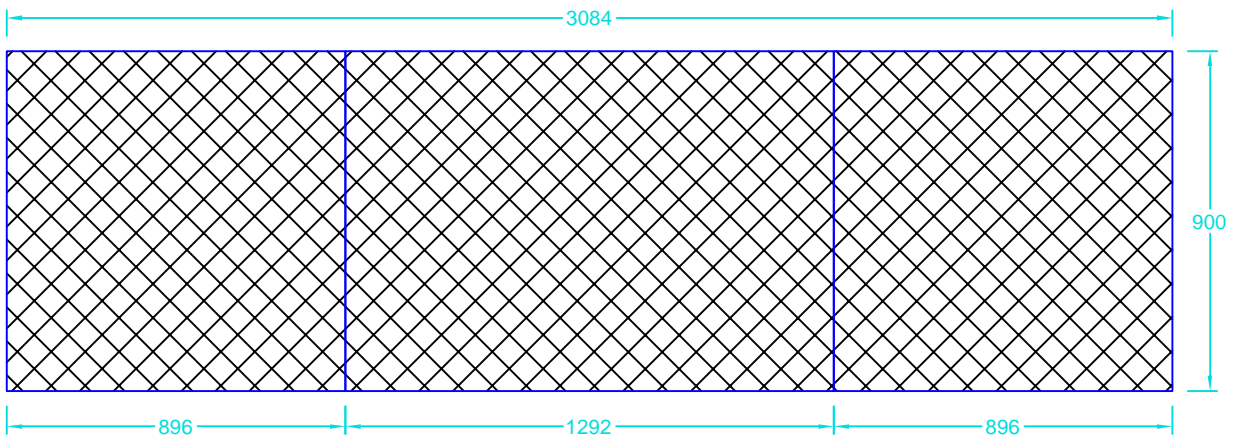

4. DETALIU SCOABA
Ø6mm, l=202mm
scara 1:10

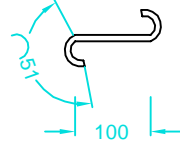

5. DETALIU PLASA SUDATA STNB DESFASURATA
Ø8mm cu ochiuri de 100 x 100mm (tip Buzau), l=2716mm
scara 1:20

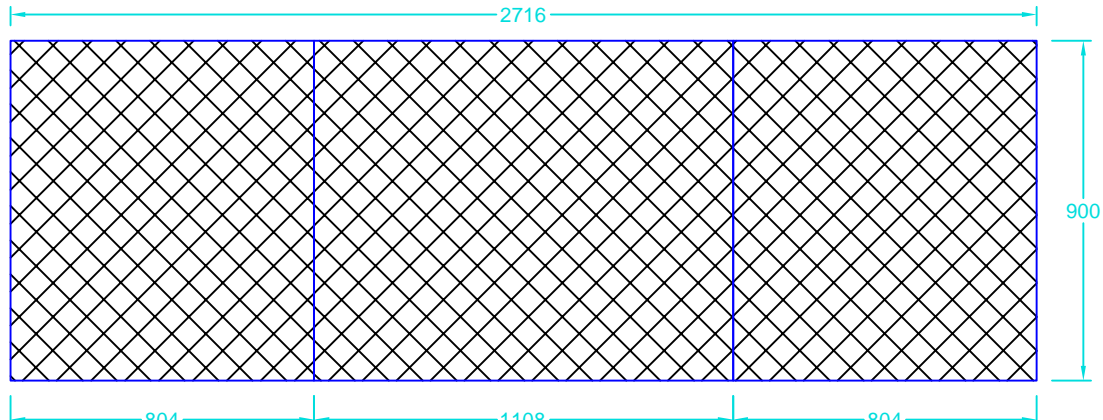

TOTAL PENTRU "N" PERECHI [Kg] =								4	317.26
TOTAL PENTRU O PERECHE INSULE [Kg] =									79.31
6	Plasa sudata		3084 x 900	7.90	2.77	-	21.883	1	21.88
5	Plasa sudata		2716 x 900	7.90	2.44	-	19.276	1	19.28
4	Scoaba	OB 37	Ø6	0.222	-	0.202	0.045	40	1.79
3	Plasa sudata		3084 x 900	7.90	2.35	-	18.565	1	18.57
2	Plasa sudata		2716 x 900	7.90	2.02	-	15.958	1	15.96
1	Scoaba	OB 37	Ø6	0.222	-	0.202	0.045	41	1.84
Poz	Denumire	Material	Dim. [mm]	Kg/ml Kg/mp	Aria/buc. [mp]	Lungime [ml]	Kg/buc	Nr. buc	Masa totala [Kg]

Beton-C20/25-P8-T3-I32.5/0.16
Volum beton insula TIP A - V= 0.57mc
Volum beton insula TIP B - V= 0.64mc
Armatura plasa sudata STNB 8 x100x100-Indicativ 117GQ 283
Strat de acoperire a= 5 cm

Verificator/ Expert	Nume	Semnatura	Cerinta	Referat / Expertiza Nr. / Data
S.C. SNIF PROIECT S.A. Targoviste Numar de inmatriculare J15/925/2005			Beneficiar: CONPET S.A. PLOIESTI	
			Pr. nr. 309	
Specificatie	Nume	Semnatura	Scara: 1:20 1:10	Intocire conducta de transport hidroizolant zonele: Crivat-Catunu pe o lungime de cca. 550m+30m foraj orizontal subtraversare DN 1A Bucuresti-Ploiesti, loc. Ghimpati - traversare rau Colentina pe o lungime de cca. 500m si loc. Stantu Gheorghe - Crevedia Mica, pe o lungime de cca. 1.100m, cu un total de 2.180m pe fir
Sef proiect	Ing. Costea Paul			
Desenat	Ing. Radu Florin		Data: 2015	
Sef proiect	Ing. Costea Paul			
Detaliu armare insula de protectie				Pl. nr. 25